

Airline

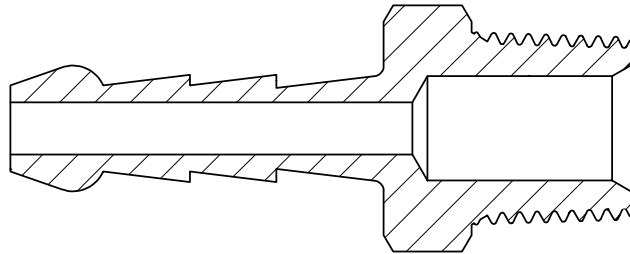

Using a special beaded barb design, TITON airline fittings provide unparalleled security against the hose pulling off the barb. They are available in sizes ranging from 3/16" to 1", and are manufactured from high quality DZR brass alloy.

ADVANTAGES

Almost impossible to pull hose off. The 6° barbs give exceptional sealing properties, while the end bead provides a shoulder preventing any longitudinal movement of the hose. For added integrity two hose clips may be used.

APPLICATIONS

Use with all rubber, plastic and other flexible hoses. Generally used where lower pressures (750 kPa) are encountered, although with the correct selection of hose and clamp, higher pressures can be accommodated.

WORKING PRESSURES

TITON AirLine Fittings should be used where lower pressures exist (1000 kPa [145 PSI] maximum).

ASSEMBLY

- I. Slide clamp onto hose.
- II. Push hose fully onto barb.
- III. Position clamp in the centre of the barb and tighten.

SPECIAL SIZES

Other sizes not specified are available upon request.

Airline

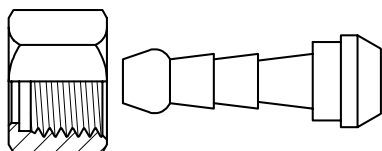
201

Swivel Connector

Part Number	Standard Pack	Tube	Pipe Thread
2010302	50	3/16	G 1/8
2010304	50	3/16	G 1/4
2010404	50	1/4	G 1/4
2010406	50	1/4	G 3/8
2010408	50	1/4	G 1/2
2010504	50	5/16	G 1/4
2010506	25	5/16	G 3/8
2010508	25	5/16	G 1/2
2010604	25	3/8	G 1/4
2010606	25	3/8	G 3/8
2010608	25	3/8	G 1/2
2010806	25	1/2	G 3/8
2010808	25	1/2	G 1/2
2011212	5	3/4	G 3/4
2011616	5	1"	G 1"

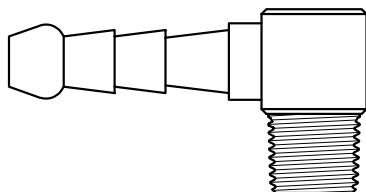
202

Male Elbow

Part Number	Standard Pack	Tube	Pipe Thread
2020302	25	3/16	1/8 BSPT
2020402	25	1/4	1/8 BSPT
2020404	25	1/4	1/4 BSPT
2020502	25	5/16	1/8 BSPT
2020504	25	5/16	1/4 BSPT
2020602	25	3/8	1/8 BSPT
2020604	20	3/8	1/4 BSPT
2020606	20	3/8	3/8 BSPT
2020804	20	1/2	1/4 BSPT
2020806	20	1/2	3/8 BSPT
2020808	10	1/2	1/2 BSPT
2021006	10	5/8	3/8 BSPT
2021008	1	5/8	3/8 BSPT
2021208	1	3/4	1/2 BSPT
2021212	1	3/4	3/4 BSPT
2021612	1	1"	3/4 BSPT
2021616	1	1"	1" BSPT

A
I
R
L
I
N
E

Airline

AirLine Tee

Part Number	Standard Pack	Tube	Pipe Thread
20303	10	3/16	-
20304	10	1/4	-
20305	10	5/16	-
20306	10	3/8	-
20308	10	1/2	-
20310	10	5/8	-
20312	1	3/4	-
20316	1	1"	-

203

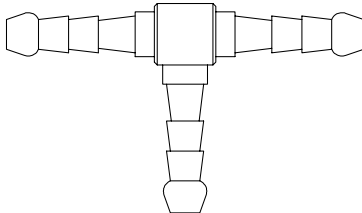

AirLine Elbow

Part Number	Standard Pack	Tube	Pipe Thread
20403	25	3/16	-
20404	25	1/4	-
20405	20	5/16	-
20406	20	3/8	-
20408	20	1/2	-
20410	10	5/8	-
20412	1	3/4	-

204

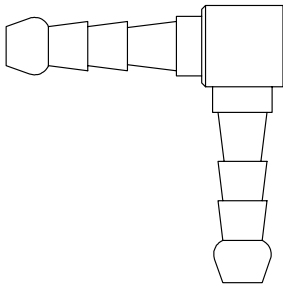

AirLine Joiner

Part Number	Standard Pack	Tube	Pipe Thread
20503	25	3/16	-
20504	25	1/4	-
20505	20	5/16	-
20506	20	3/8	-
20508	20	1/2	-
20510	10	5/8	-
20512	10	3/4	-
20516	10	1"	-

205

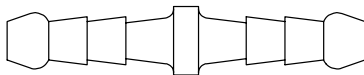

Airline

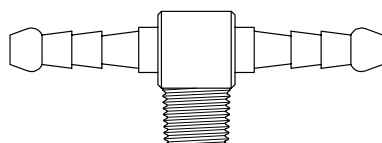
206

Male Branch Tee

Part Number	Standard Pack	Tube	Pipe Thread
2060302	20	3/16	1/8 BSPT
2060402	20	1/4	1/8 BSPT
2060404	20	1/4	1/4 BSPT
2060502	20	5/16	1/8 BSPT
2060504	20	5/16	1/4 BSPT
2060602	20	3/8	1/8 BSPT
2060604	20	3/8	1/4 BSPT
2060606	20	3/8	3/8 BSPT
2060806	20	1/2	3/8 BSPT
2060808	10	1/2	1/2 BSPT
2061006	10	5/8	3/8 BSPT
2061212	1	3/4	3/4 BSPT

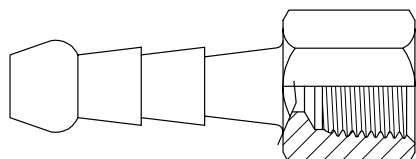
207

Female Connector

Part Number	Standard Pack	Tube	Pipe Thread
2070302	50	3/16	1/8 BSPP
2070304	50	3/16	1/4 BSPP
2070402	50	1/4	1/8 BSPP
2070404	25	1/4	1/4 BSPP
2070406	25	1/4	3/8 BSPP
2070408	25	1/4	1/2 BSPP
2070502	25	5/16	1/8 BSPP
2070504	25	5/16	1/4 BSPP
2070506	25	5/16	3/8 BSPP
2070602	25	3/8	1/8 BSPP
2070604	20	3/8	1/4 BSPP
2070606	20	3/8	3/8 BSPP
2070608	20	3/8	1/2 BSPP
2070804	20	1/2	1/4 BSPP
2070806	20	1/2	3/8 BSPP
2070808	10	1/2	1/2 BSPP
2071006	10	5/8	3/8 BSPP
2071212	-	3/4	3/4 BSPP

A
I
R
L
I
N
E

Airline

Male Connector

209

Part Number	Standard Pack	Tube	Pipe Thread
2090302	50	3/16	1/8 BSPT
2090304	50	3/16	1/4 BSPT
2090402	50	1/4	1/8 BSPT
2090404	25	1/4	1/4 BSPT
2090406	25	1/4	3/8 BSPT
2090408	25	1/4	1/2 BSPT
2090412	25	1/4	3/4 BSPT
2090502	25	5/16	1/8 BSPT
2090504	25	5/16	1/4 BSPT
2090506	25	5/16	3/8 BSPT
2090508	25	5/16	1/2 BSPT
2090602	25	3/8	1/8 BSPT
2090604	20	3/8	1/4 BSPT
2090606	20	3/8	3/8 BSPT
2090608	20	3/8	1/2 BSPT
2090612	20	3/8	3/4 BSPT
2090802	-	1/2	1/8 BSPT
2090804	20	1/2	1/4 BSPT
2090806	20	1/2	3/8 BSPT
2090808	10	1/2	1/2 BSPT
2090812	10	1/2	3/4 BSPT
2091004	10	5/8	1/4 BSPT
2091006	10	5/8	3/8 BSPT
2091008	10	5/8	1/2 BSPT
2091012	10	5/8	3/4 BSPT
2091204	10	3/4	1/4 BSPT
2091206	10	3/4	3/8 BSPT
2091208	10	3/4	1/2 BSPT
2091212	5	3/4	3/4 BSPT
2091216	5	3/4	1" BSPT
2091608	5	1"	1/2 BSPT
2091612	5	1"	3/4 BSPT
2091616	5	1"	1" BSPT

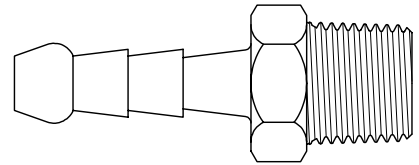

**A
I
R
L
I
N
E**

Airline

209ST

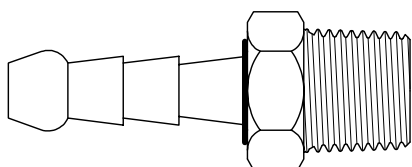

Swivel Male Connector

Hose Is Free To Rotate Independently.

Part Number	Standard Pack	Tube	Pipe Thread
209ST0404	-	1/4	1/4 BSPT
209ST0606	-	5/16	3/8 BSPT
209ST0808	-	3/8	1/2 BSPT
209ST1212	-	1/2	3/4 BSPT

A
I
R
L
I
N
E

NPT Pipe Fittings

NPT3200BSP

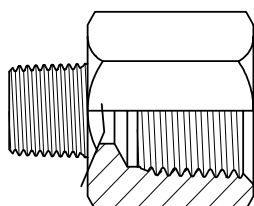

Male BSP to Female NPT adaptor

Part Number	Standard Pack	Pipe Thread (Male)	Pipe Thread (Female)
NPT32000202BSP	1	1/8 NPT	1/8 BSPT
NPT32000404BSP	1	1/4 NPT	1/4 BSPT
NPT32000606BSP	1	3/8 NPT	3/8 BSPT
NPT32000808BSP	1	1/2 NPT	

3300NPT

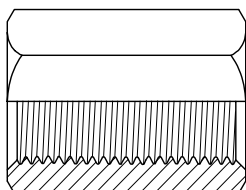

NPT Hex Socket

Part Number	Standard Pack	NPT Thread
330002NPT	1	1/8
330004NPT	1	1/4
330006NPT	1	3/8

3152NPT

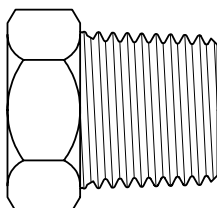

NPT Hex Plug

Available In Hollow and Solid Configuration

Part Number	Standard Pack	NPT Thread
315202NPT	1	1/8
315204NPT	1	1/4
315206NPT	1	3/8
315208NPT	1	1/2

P
I
P
E

Airbrake

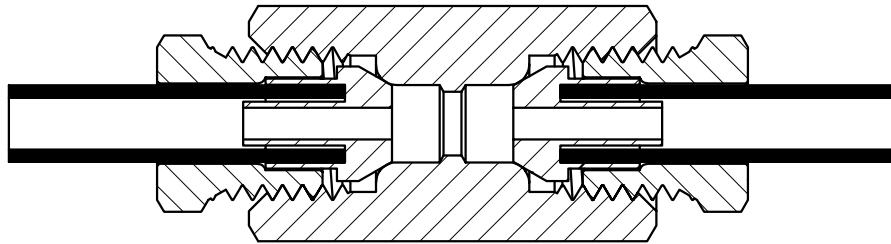

TITON Airbrake Fittings are based on a highly reliable proven design. They are available in sizes ranging from 1/8" to 1/2", and are manufactured from high quality DZR brass alloy.

ADVANTAGES

Simple to assemble/disassemble, no flaring or other special tools are required. Proven design.

APPLICATIONS

Used in heavy vehicle air braking systems, and where high reliability is required. Only recommended air brake tubing should be used with these fittings.

WORKING PRESSURES

TITON Airbrake Fittings should be used where pressures do not exceed 850 kPa [125 PSI]..

ASSEMBLY

- I. Slide nut, hex end first, onto plastic tube
- II. Push sleeve fully onto tube end.
- III. Screw into fitting body and tighten until a good seal is achieved. NOTE: Over-tightening may lead to premature failure of the fitting.

Airbrake

NF100

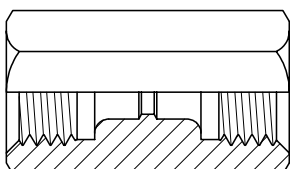

Airbrake Connector

Part Number	Standard Pack	Tube	Thread
NF10003	20	1/8	3/8 UNF
NF10004	20	1/4	7/16 UNF
NF10005	20	5/16	1/2 UNF
NF10006	10	3/8	9/16 UNF
NF10008	10	1/2	3/4 UNF

NF103

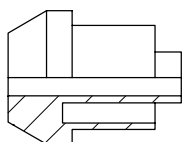

Airbrake Sleeve

Part Number	Standard Pack	Tube	Pipe Thread
NF10303	20	3/16	-
NF10304	20	1/4	-
NF10305	20	5/16	-
NF10306	10	3/8	-
NF10308	10	1/2	-

NF104

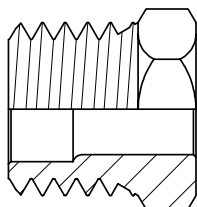

Airbrake Nut

Part Number	Standard Pack	Tube	Thread
NF10403	20	3/16	3/8 UNF
NF10404	20	1/4	7/16 UNF
NF10405	20	5/16	1/2 UNF
NF10406	20	3/8	9/16 UNF
NF10408	10	1/2	3/4 UNF

NF105 BSPT BF105 NPT

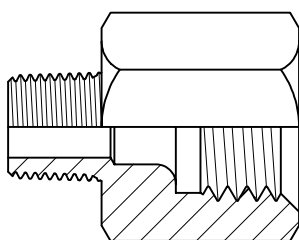

Airbrake Adaptor

Part Number	Standard Pack	Tube	Thread	Pipe Thread
NF1050302	20	3/16	3/8 UNF	1/8 BSPT
NF1050402	20	1/4	7/16 UNF	1/8 BSPT
NF1050404	20	1/4	7/16 UNF	1/4 BSPT
NF1050502	10	5/16	1/2 UNF	1/8 BSPT
NF1050504	10	5/16	1/2 UNF	1/4 BSPT
NF1050602	10	3/8	9/16 UNF	1/8 BSPT
NF1050604	10	3/8	9/16 UNF	1/4 BSPT
NF1050606	-	3/8	9/16 UNF	3/8 BSPT
NF1050804	5	1/2	3/4 UNF	1/4 BSPT
NF1050806	5	1/2	3/4 UNF	3/8 BSPT

Airbrake

**A
I
R
B
R
A
K
E**

Airbrake Male Elbow

Part Number	Standard Pack	Tube	Thread	Pipe Thread
NF1080302	20	3/16	3/8 UNF	1/8 BSPT
NF1080402	20	1/4	7/16 UNF	1/8 BSPT
NF1080404	20	1/4	7/16 UNF	1/4 BSPT
NF1080502	10	5/16	1/2 UNF	1/8 BSPT
NF1080504	10	5/16	1/2 UNF	1/4 BSPT
NF1080604	10	3/8	9/16 UNF	1/4 BSPT
NF1080606	5	3/8	9/16 UNF	3/8 BSPT
NF1080806	-	1/2	3/4 UNF	3/8 BSPT

NF108

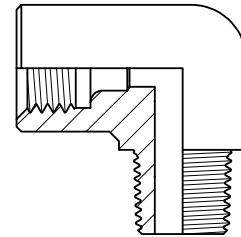

Airbrake Tee

Part Number	Standard Pack	Tube	Thread
NF11004	20	1/4	7/16 UNF
NF11006	10	3/8	9/16 UNF

NF110

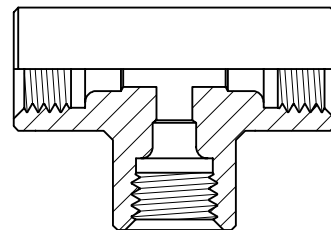

Miscellaneous

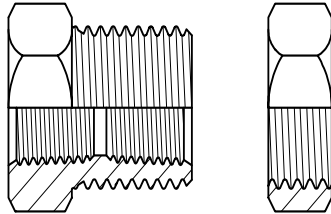
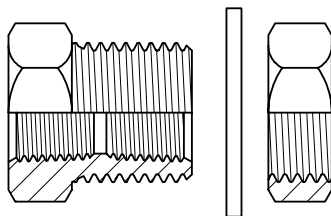
<div>BUL</div> <div></div>	<div>Lightweight Bulkhead Union</div> <div>Complete with nut.</div> <table><tr><th>Part Number</th><th>Standard Pack</th><th>Length (mm)</th><th>Male Thread</th><th>Pipe Thread</th></tr><tr><td>BU02L</td><td>2</td><td>27</td><td>1/4 BSPF</td><td>1/8 BSPP</td></tr><tr><td>BU04L</td><td>2</td><td>30</td><td>3/8 BSPF</td><td>1/4 BSPP</td></tr></table>	Part Number	Standard Pack	Length (mm)	Male Thread	Pipe Thread	BU02L	2	27	1/4 BSPF	1/8 BSPP	BU04L	2	30	3/8 BSPF	1/4 BSPP													
Part Number	Standard Pack	Length (mm)	Male Thread	Pipe Thread																									
BU02L	2	27	1/4 BSPF	1/8 BSPP																									
BU04L	2	30	3/8 BSPF	1/4 BSPP																									
<div>BU</div> <div></div>	<div>Bulkhead Union</div> <div>Complete with lock washer and nut.</div> <table><tr><th>Part Number</th><th>Standard Pack</th><th>Length (Inches)</th><th>Male Thread</th><th>Pipe Thread</th></tr><tr><td>BU02</td><td>2</td><td>1.5</td><td>5/8 UNF</td><td>1/8 BSPT</td></tr><tr><td>BU04</td><td>2</td><td>1.5</td><td>3/4 UNF</td><td>1/4 BSPT</td></tr><tr><td>BU06</td><td>2</td><td>1.5</td><td>7/8 UNF</td><td>3/8 BSPT</td></tr></table>	Part Number	Standard Pack	Length (Inches)	Male Thread	Pipe Thread	BU02	2	1.5	5/8 UNF	1/8 BSPT	BU04	2	1.5	3/4 UNF	1/4 BSPT	BU06	2	1.5	7/8 UNF	3/8 BSPT								
Part Number	Standard Pack	Length (Inches)	Male Thread	Pipe Thread																									
BU02	2	1.5	5/8 UNF	1/8 BSPT																									
BU04	2	1.5	3/4 UNF	1/4 BSPT																									
BU06	2	1.5	7/8 UNF	3/8 BSPT																									
<div>111</div> <div></div>	<div>Lock Nut</div> <table><tr><th>Part Number</th><th>Standard Pack</th><th>Tube</th><th>Thread</th></tr><tr><td>11102</td><td>5</td><td>-</td><td>G 1/8</td></tr><tr><td>11104</td><td>5</td><td>-</td><td>G 1/4</td></tr><tr><td>11106</td><td>5</td><td>-</td><td>G 3/8</td></tr><tr><td>11108</td><td>5</td><td>-</td><td>G 1/2</td></tr><tr><td>11112</td><td>-</td><td>-</td><td>G 3/4</td></tr><tr><td>11116</td><td>1</td><td>-</td><td>G 1"</td></tr></table>	Part Number	Standard Pack	Tube	Thread	11102	5	-	G 1/8	11104	5	-	G 1/4	11106	5	-	G 3/8	11108	5	-	G 1/2	11112	-	-	G 3/4	11116	1	-	G 1"
Part Number	Standard Pack	Tube	Thread																										
11102	5	-	G 1/8																										
11104	5	-	G 1/4																										
11106	5	-	G 3/8																										
11108	5	-	G 1/2																										
11112	-	-	G 3/4																										
11116	1	-	G 1"																										

**M
I
S
C**

Compression Fittings

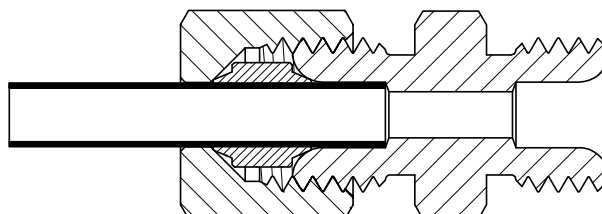

TITON Compression Fittings are designed to comply with established industry standards. This economical fitting is available in a wide range of off-the-shelf sizes and styles. They are manufactured from high quality DZR brass alloy.

ADVANTAGES

Simple to assemble. No soldering, flaring or deburring is necessary. Suitable for use in a wide variety of applications.

APPLICATIONS

May be used with copper, aluminium, brass, and plastic tubing. Use with steel tubing is not recommended. Installation should be where low to medium pressures are encountered, and modest tube vibration/movement is involved. Suitable for hazardous liquids, oils, and fuel. **Not recommended for use with gas**

WORKING PRESSURES

Generally, working pressure is dependant upon the type of tubing used and not the fitting. Consequently the table shown below should be used as a guide only.

ASSEMBLY

- I. Slide nut then sleeve onto tube ensuring threaded end of nut is facing the sleeve.
- II. If using a plastic tube, push a 261 Insert into tube to prevent tube from collapsing.
- III. Insert the tube into the fitting until the tube has bottomed onto the fitting shoulder.
- IV. Screw nut onto the fitting and tighten "hand tight". **Using the table below, follow the number of additional wrench turns.**

Tube Size	Hydraulic kPa [PSI]	Pneumatic kPa [PSI]	Wrench Turns
1/8	3500 [500]	2000 [290]	1/1
1/3	3500 [500]	1750 [250]	1/1
1/4	2750 [400]	1400 [200]	1/1
1/5	2750 [400]	1400 [200]	1/1
3/8	2000 [290]	1050 [150]	1/1
1/2	2000 [290]	1050 [150]	1½
5/8	1400 [200]	700 [100]	1½
3/4	1400 [200]	700 [100]	1½

Compression Fittings

**C
O
M
P**

60N

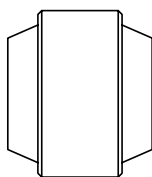

Sleeve

For All Materials. Ideal For Nylon

Part Number	Standard Pack	Tube	Pipe Thread
60N02	100	1/8	-
60N03	100	3/16	-
60N04	100	1/4	-
60N05	100	5/16	-
60N06	100	3/8	-
60N08	50	1/2	-
60N10	50	5/8	-
60N12	50	3/4	-
60N16	1	1"	-

60

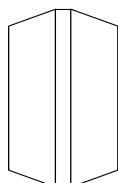

Sleeve

Ideal For Copper

Part Number	Standard Pack	Tube	Pipe Thread
6002	100	1/8	-
6003	100	3/16	-
6004	100	1/4	-
6005	100	5/16	-
6006	100	3/8	-
6008	50	1/2	-
6010	50	5/8	-
6012	50	3/4	-

61

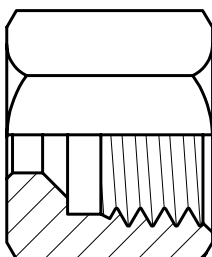

Compression Nut

Part Number	Standard Pack	Tube	Pipe Thread
6102	50	1/8	-
6103	50	3/16	-
6104	50	1/4	-
6105	50	5/16	-
6106	50	3/8	-
6108	25	1/2	-
6110	15	5/8	-
6112	15	3/4	-
6116	1	1"	-

Compression Fittings

**C
O
M
P**

Compression Fittings

COMP

64

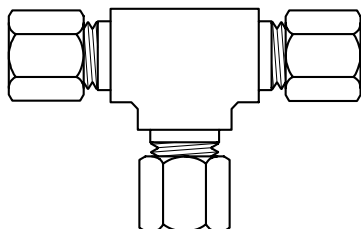

Union Tee

Supplied Complete With 60N Sleeves and 61 Nuts.

Part Number	Standard Pack	Tube	Pipe Thread
6402	20	1/8	-
6403	10	3/16	-
6404	10	1/4	-
6405	10	5/16	-
6406	10	3/8	-
6408	10	1/2	-
6410	5	5/8	-
6412	-	3/4	-

65

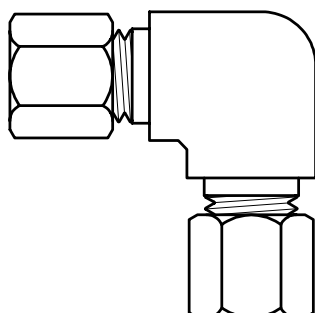

Union Elbow

Supplied Complete With 60N Sleeves and 61 Nuts.

Part Number	Standard Pack	Tube	Pipe Thread
6502	20	1/8	-
6503	20	3/16	-
6504	20	1/4	-
6505	20	5/16	-
6506	10	3/8	-
6508	10	1/2	-
6510	-	5/8	-
6512	-	3/4	-

66

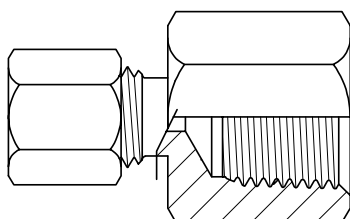

Female Connector

Supplied Complete With 60N Sleeves and 61 Nuts.

Part Number	Standard Pack	Tube	Pipe Thread
660202	20	1/8	1/8 BSPP
660302	20	3/16	1/8 BSPP
660402	20	1/4	1/8 BSPP
660404	20	1/4	1/4 BSPP
660406	20	1/4	3/8 BSPP
660408	10	1/4	1/2 BSPP
660502	20	5/16	1/8 BSPP
660504	20	5/16	1/4 BSPP
660506	20	5/16	3/8 BSPP

Continued on next page...

Compression Fittings

...Continued from previous page.

Female Connector

Part Number	Standard Pack	Tube	Pipe Thread
660602	20	3/8	1/8 BSPP
660604	20	3/8	1/4 BSPP
660606	20	3/8	3/8 BSPP
660608	20	3/8	1/2 BSPP
660806	10	1/2	3/8 BSPP
660808	10	1/2	1/2 BSPP
661208	-	3/4	1/2 BSPP
661212	-	3/4	3/4 BSPP

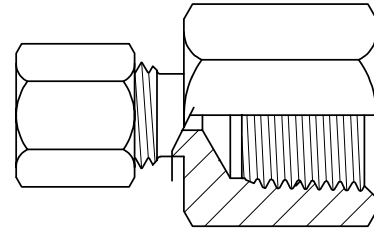
66
**C
O
M
P**

Male Connector

Supplied Complete With 60N Sleeves and 61 Nuts

Part Number	Standard Pack	Tube	Pipe Thread
680202	20	1/8	1/8 BSPT
680204	20	1/8	1/4 BSPT
680302	20	3/16	1/8 BSPT
680304	20	3/16	1/4 BSPT
680402	25	1/4	1/8 BSPT
680404	25	1/4	1/4 BSPT
680406	20	1/4	3/8 BSPT
680408	10	1/4	1/2 BSPT
680412	10	1/4	3/4 BSPT
680502	25	5/16	1/8 BSPT
680504	25	5/16	1/4 BSPT
680506	20	5/16	3/8 BSPT
680508	10	5/16	1/2 BSPT
680602	20	3/8	1/8 BSPT
680604	25	3/8	1/4 BSPT
680606	10	3/8	3/8 BSPT
680608	20	3/8	1/2 BSPT
680804	10	1/2	1/4 BSPT
680806	20	1/2	3/8 BSPT
680808	10	1/2	1/2 BSPT
680812	10	1/2	3/4 BSPT
681006	10	5/8	3/8 BSPT
681008	10	5/8	1/2 BSPT
681012	10	5/8	3/4 BSPT
681204	-	3/4	1/4 BSPT
681208	5	3/4	1/2 BSPT
681212	5	3/4	3/4 BSPT
681616	2	1"	1" BSPT

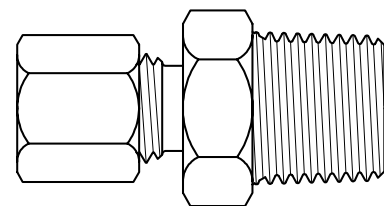

68

Compression Fittings

69

Male Elbow

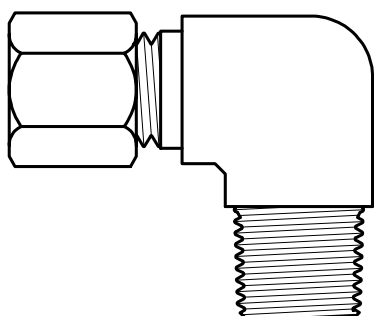
Supplied Complete With 60N Sleeves and 61 Nuts.



Part Number	Standard Pack	Tube	Pipe Thread
690202	20	1/8	1/8 BSPT
690302	20	3/16	1/8 BSPT
690402	20	1/4	1/8 BSPT
690404	20	1/4	1/4 BSPT
690406	20	1/4	3/8 BSPT
690502	20	5/16	1/8 BSPT
690504	20	5/16	1/4 BSPT
690602	20	3/8	1/8 BSPT
690604	20	3/8	1/4 BSPT
690606	10	3/8	3/8 BSPT
690608	10	3/8	1/2 BSPT
690804	10	1/2	1/4 BSPT
690806	10	1/2	3/8 BSPT
690808	10	1/2	1/2 BSPT
691006	5	5/8	3/8 BSPT
691008	5	5/8	1/2 BSPT
691208	5	3/4	1/2 BSPT
691212	1	3/4	3/4 BSPT

70

Female Elbow

Supplied Complete With 60N Sleeves and 61 Nuts.

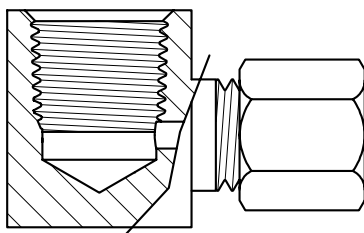

Part Number	Standard Pack	Tube	Pipe Thread
700202	20	1/8	1/8 BSPP
700302	20	3/16	1/8 BSPP
700402	20	1/4	1/8 BSPP
700604	10	3/8	1/4 BSPP
700806	10	1/2	3/8 BSPP

Compression Fittings

**C
O
M
P**

Union Male Run Tee

Supplied Complete With 60N Sleeves and 61 Nuts.

Part Number	Standard Pack	Tube	Pipe Thread
710202	10	1/8	1/8 BSPT
710302	10	3/16	1/8 BSPT
710402	10	1/4	1/8 BSPT
710404	10	1/4	1/4 BSPT
710502	10	5/16	1/8 BSPT
710504	10	5/16	1/4 BSPT
710604	10	3/8	1/4 BSPT
710806	5	1/2	3/8 BSPT

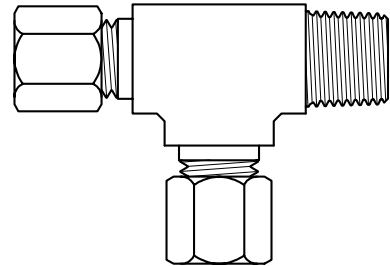

71

Union Male Branch Tee

Supplied Complete With 60N Sleeves and 61 Nuts

Part Number	Standard Pack	Tube	Pipe Thread
720202	20	1/8	1/8 BSPT
720302	20	3/16	1/8 BSPT
720402	10	1/4	1/8 BSPT
720404	10	1/4	1/4 BSPT
720502	10	5/16	1/8 BSPT
720504	10	5/16	1/4 BSPT
720604	10	3/8	1/4 BSPT
720606	1	3/8	3/8 BSPT
720804	1	1/2	1/4 BSPT
720806	1	1/2	3/8 BSPT

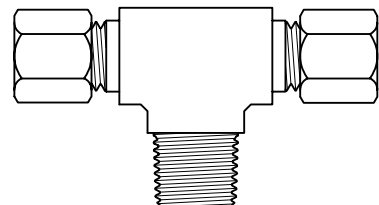

72

Male/Female Run Tee

Supplied Complete With 60N Sleeves and 61 Nuts

Part Number	Standard Pack	Tube	Pipe Thread
760202	10	1/8	1/8 BSPT
760302	10	3/16	1/8 BSPT
760402	10	1/4	1/8 BSPT
760502	10	5/16	1/8 BSPT
760604	10	3/8	1/4 BSPT

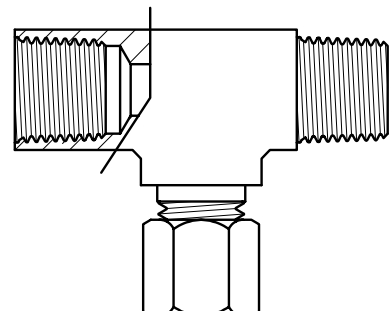

76

Airline

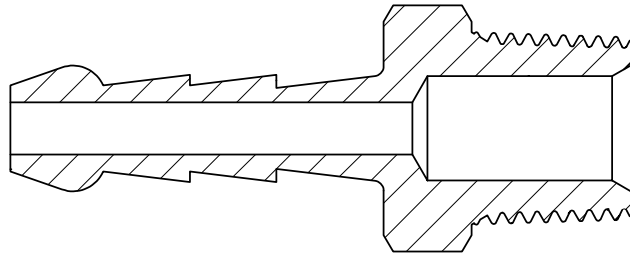

Using a special beaded barb design, TITON airline fittings provide unparalleled security against the hose pulling off the barb. They are available in sizes ranging from 3/16" to 1", and are manufactured from high quality DZR brass alloy.

ADVANTAGES

Almost impossible to pull hose off. The 6° barbs give exceptional sealing properties, while the end bead provides a shoulder preventing any longitudinal movement of the hose. For added integrity two hose clips may be used.

APPLICATIONS

Use with all rubber, plastic and other flexible hoses. Generally used where lower pressures (750 kPa) are encountered, although with the correct selection of hose and clamp, higher pressures can be accommodated.

WORKING PRESSURES

TITON AirLine Fittings should be used where lower pressures exist (1000 kPa [145 PSI] maximum).

ASSEMBLY

- I. Slide clamp onto hose.
- II. Push hose fully onto barb.
- III. Position clamp in the centre of the barb and tighten.

SPECIAL SIZES

Other sizes not specified are available upon request.

Airline

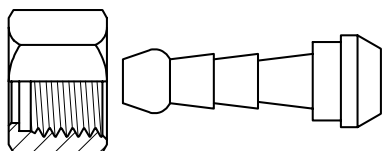
201

Swivel Connector

Part Number	Standard Pack	Tube	Pipe Thread
2010302	50	3/16	G 1/8
2010304	50	3/16	G 1/4
2010404	50	1/4	G 1/4
2010406	50	1/4	G 3/8
2010408	50	1/4	G 1/2
2010504	50	5/16	G 1/4
2010506	25	5/16	G 3/8
2010508	25	5/16	G 1/2
2010604	25	3/8	G 1/4
2010606	25	3/8	G 3/8
2010608	25	3/8	G 1/2
2010806	25	1/2	G 3/8
2010808	25	1/2	G 1/2
2011212	5	3/4	G 3/4
2011616	5	1"	G 1"

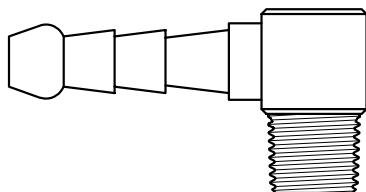
202

Male Elbow

Part Number	Standard Pack	Tube	Pipe Thread
2020302	25	3/16	1/8 BSPT
2020402	25	1/4	1/8 BSPT
2020404	25	1/4	1/4 BSPT
2020502	25	5/16	1/8 BSPT
2020504	25	5/16	1/4 BSPT
2020602	25	3/8	1/8 BSPT
2020604	20	3/8	1/4 BSPT
2020606	20	3/8	3/8 BSPT
2020804	20	1/2	1/4 BSPT
2020806	20	1/2	3/8 BSPT
2020808	10	1/2	1/2 BSPT
2021006	10	5/8	3/8 BSPT
2021008	1	5/8	3/8 BSPT
2021208	1	3/4	1/2 BSPT
2021212	1	3/4	3/4 BSPT
2021612	1	1"	3/4 BSPT
2021616	1	1"	1" BSPT

A
I
R
L
I
N
E

Airline

AirLine Tee

Part Number	Standard Pack	Tube	Pipe Thread
20303	10	3/16	-
20304	10	1/4	-
20305	10	5/16	-
20306	10	3/8	-
20308	10	1/2	-
20310	10	5/8	-
20312	1	3/4	-
20316	1	1"	-

203

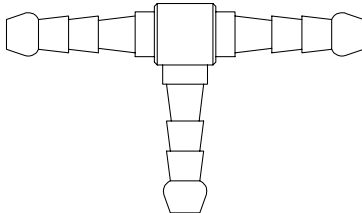

AirLine Elbow

Part Number	Standard Pack	Tube	Pipe Thread
20403	25	3/16	-
20404	25	1/4	-
20405	20	5/16	-
20406	20	3/8	-
20408	20	1/2	-
20410	10	5/8	-
20412	1	3/4	-

204

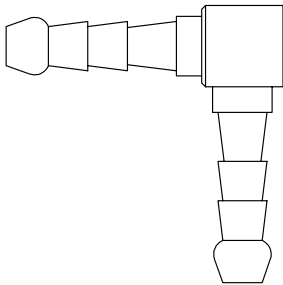

AirLine Joiner

Part Number	Standard Pack	Tube	Pipe Thread
20503	25	3/16	-
20504	25	1/4	-
20505	20	5/16	-
20506	20	3/8	-
20508	20	1/2	-
20510	10	5/8	-
20512	10	3/4	-
20516	10	1"	-

205

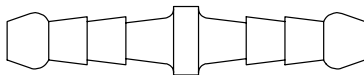

Airline

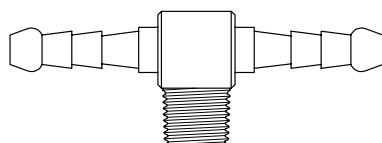
206

Male Branch Tee

Part Number	Standard Pack	Tube	Pipe Thread
2060302	20	3/16	1/8 BSPT
2060402	20	1/4	1/8 BSPT
2060404	20	1/4	1/4 BSPT
2060502	20	5/16	1/8 BSPT
2060504	20	5/16	1/4 BSPT
2060602	20	3/8	1/8 BSPT
2060604	20	3/8	1/4 BSPT
2060606	20	3/8	3/8 BSPT
2060806	20	1/2	3/8 BSPT
2060808	10	1/2	1/2 BSPT
2061006	10	5/8	3/8 BSPT
2061212	1	3/4	3/4 BSPT

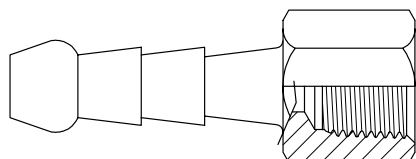
207

Female Connector

Part Number	Standard Pack	Tube	Pipe Thread
2070302	50	3/16	1/8 BSPP
2070304	50	3/16	1/4 BSPP
2070402	50	1/4	1/8 BSPP
2070404	25	1/4	1/4 BSPP
2070406	25	1/4	3/8 BSPP
2070408	25	1/4	1/2 BSPP
2070502	25	5/16	1/8 BSPP
2070504	25	5/16	1/4 BSPP
2070506	25	5/16	3/8 BSPP
2070602	25	3/8	1/8 BSPP
2070604	20	3/8	1/4 BSPP
2070606	20	3/8	3/8 BSPP
2070608	20	3/8	1/2 BSPP
2070804	20	1/2	1/4 BSPP
2070806	20	1/2	3/8 BSPP
2070808	10	1/2	1/2 BSPP
2071006	10	5/8	3/8 BSPP
2071212	-	3/4	3/4 BSPP

A
I
R
L
I
N
E

Airline

Male Connector

209

Part Number	Standard Pack	Tube	Pipe Thread
2090302	50	3/16	1/8 BSPT
2090304	50	3/16	1/4 BSPT
2090402	50	1/4	1/8 BSPT
2090404	25	1/4	1/4 BSPT
2090406	25	1/4	3/8 BSPT
2090408	25	1/4	1/2 BSPT
2090412	25	1/4	3/4 BSPT
2090502	25	5/16	1/8 BSPT
2090504	25	5/16	1/4 BSPT
2090506	25	5/16	3/8 BSPT
2090508	25	5/16	1/2 BSPT
2090602	25	3/8	1/8 BSPT
2090604	20	3/8	1/4 BSPT
2090606	20	3/8	3/8 BSPT
2090608	20	3/8	1/2 BSPT
2090612	20	3/8	3/4 BSPT
2090802	-	1/2	1/8 BSPT
2090804	20	1/2	1/4 BSPT
2090806	20	1/2	3/8 BSPT
2090808	10	1/2	1/2 BSPT
2090812	10	1/2	3/4 BSPT
2091004	10	5/8	1/4 BSPT
2091006	10	5/8	3/8 BSPT
2091008	10	5/8	1/2 BSPT
2091012	10	5/8	3/4 BSPT
2091204	10	3/4	1/4 BSPT
2091206	10	3/4	3/8 BSPT
2091208	10	3/4	1/2 BSPT
2091212	5	3/4	3/4 BSPT
2091216	5	3/4	1" BSPT
2091608	5	1"	1/2 BSPT
2091612	5	1"	3/4 BSPT
2091616	5	1"	1" BSPT

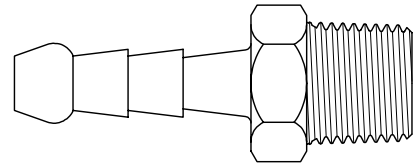
**A
I
R
L
I
N
E**

Airline

209ST

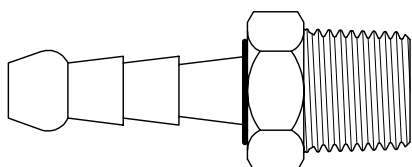

Swivel Male Connector

Hose Is Free To Rotate Independently.

Part Number	Standard Pack	Tube	Pipe Thread
209ST0404	-	1/4	1/4 BSPT
209ST0606	-	5/16	3/8 BSPT
209ST0808	-	3/8	1/2 BSPT
209ST1212	-	1/2	3/4 BSPT

A
I
R
L
I
N
E

Metric Compression Fittings

**C
O
M
P**

M60N

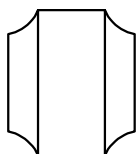

Metric Sleeve

For All Materials. Ideal For Nylon

Part Number	Standard Pack	Tube	Pipe Thread
M60N04	50	4 mm	-
M60N06	50	6 mm	-
M60N08	50	8 mm	-
M60N10	50	10 mm	-
M60N12	20	12 mm	-
M60N16	20	16 mm	-

M61

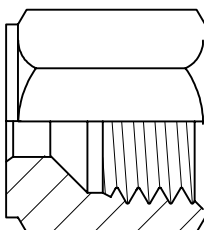

Metric Compression Nut

Part Number	Standard Pack	Tube	Pipe Thread
M6104	20	4 mm	-
M6106	20	6 mm	-
M6108	20	8 mm	-
M6110	20	10 mm	-
M6112	20	12 mm	-
M6116	10	16 mm	-

M261

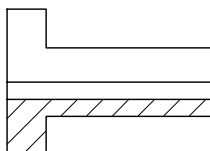

Metric Hose Insert

Provides Support For Plastic Tubes.

Part Number	Standard Pack	Tube OD	Tube ID
M26104	50	4 mm	2.25 mm
M26106	50	6 mm	3.50 mm
M26108	50	8 mm	5.05 mm
M26110	50	10 mm	6.35 mm
M26112	50	12 mm	8.40 mm

Metric Compression Fittings

**C
O
M
P**

Metric Double Union

Supplied Complete With M60N Sleeves and M61 Nuts

Part Number	Standard Pack	Tube	Pipe Thread
M6204	10	4 mm	-
M6206	10	6 mm	-
M6208	10	8 mm	-
M6210	10	10 mm	-
M6212	5	12 mm	-
M6216	5	16 mm	-

M62

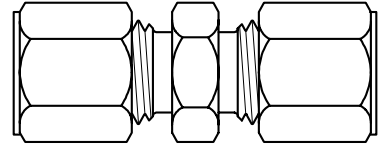

Metric Union Tee

Supplied Complete With M60N Sleeves and M61 Nuts

Part Number	Standard Pack	Tube	Pipe Thread
M6404	1	4 mm	-
M6406	1	6 mm	-
M6408	1	8 mm	-
M6410	1	10 mm	-
M6412	1	12 mm	-
M6416	1	16 mm	-

M64

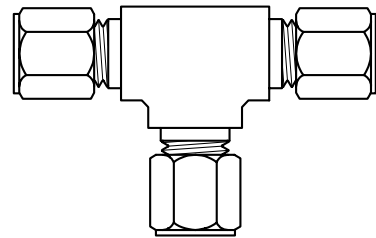

Metric Union Elbow

Supplied Complete With M60N Sleeves and M61 Nuts

Part Number	Standard Pack	Tube	Pipe Thread
M6504	1	4 mm	-
M6506	1	6 mm	-
M6508	1	8 mm	-
M6510	1	10 mm	-
M6512	1	12 mm	-
M6516	1	16 mm	-

M65

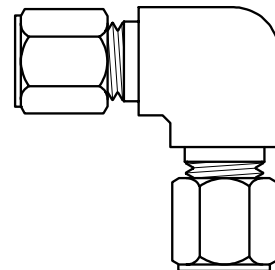

Metric Female Connector

Supplied Complete With M60N Sleeves and M61 Nuts

Part Number	Standard Pack	Tube	Pipe Thread
M660604	1	6 mm	1/4 BSPP
M660804	1	8 mm	1/4 BSPP
M661004	1	10 mm	1/4 BSPP
M661006	1	10 mm	3/8 BSPP
M661208	1	12 mm	1/2 BSPP

M66

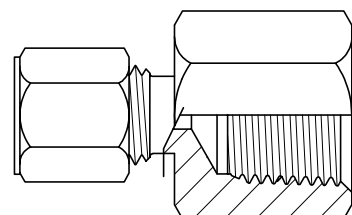

Metric Compression Fittings

**C
O
M
P**

M68

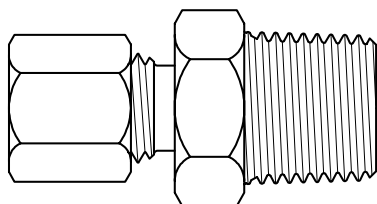

Metric Male Connector

Supplied Complete With M60N Sleeves and M61 Nuts.

Part Number	Standard Pack	Tube	Pipe Thread
M680402	10	4 mm	1/8 BSPT
M680404	10	4 mm	1/4 BSPT
M680602	10	6 mm	1/8 BSPT
M680604	10	6 mm	1/4 BSPT
M680606	10	6 mm	3/8 BSPT
M680802	10	8 mm	1/8 BSPT
M680804	10	8 mm	1/4 BSPT
M680806	10	8 mm	3/8 BSPT
M680808	10	8 mm	1/2 BSPT
M681002	10	10 mm	1/8 BSPT
M681004	10	10 mm	1/4 BSPT
M681006	10	10 mm	3/8 BSPT
M681008	10	10 mm	1/2 BSPT
M681204	10	12 mm	1/4 BSPT
M681206	10	12 mm	3/8 BSPT
M681208	10	12 mm	1/2 BSPT
M681606	5	16 mm	3/9 BSPT
M681608	5	16 mm	1/2 BSPT

M69

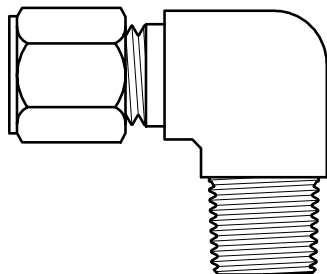

Metric Male Elbow

Supplied Complete With M60N Sleeves and M61 Nuts.

Part Number	Standard Pack	Tube	Pipe Thread
M690402	10	4 mm	1/8 BSPT
M690404	10	4 mm	1/4 BSPT
M690602	10	6 mm	1/8 BSPT
M690604	10	6 mm	1/4 BSPT
M690606	10	6 mm	3/8 BSPT
M690802	10	8 mm	1/8 BSPT
M690804	10	8 mm	1/4 BSPT
M690806	10	8 mm	3/8 BSPT
M691002	10	10 mm	1/8 BSPT
M691004	10	10 mm	1/4 BSPT
M691006	10	10 mm	3/8 BSPT
M691204	5	12 mm	1/4 BSPT
M691206	5	12 mm	3/8 BSPT
M691208	5	12 mm	1/2 BSPT

Pipe Fittings

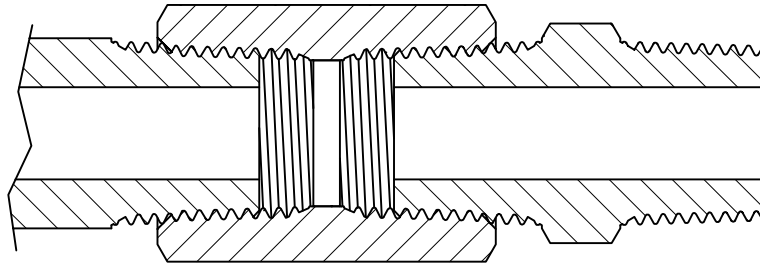

Standard TITON Pipe Fittings are manufactured with female R Series and male BSPT threads in accordance with AS1772. These robust fittings are available in a comprehensive range of sizes ranging from 1/8" to 1". They are manufactured from high quality DZR brass alloy. Some fittings are available with NPT threads. Please contact Titon for stock availability.

ADVANTAGES

Very easy to assemble. No special tools or extra parts are necessary. May be assembled/disassembled numerous times.

APPLICATIONS

May be used with copper, steel, or brass pipe. Install where medium to high pressures are encountered. Pipe Fittings provide good resistance to vibration. Ideal for use in pneumatic and hydraulic control equipment.

WORKING PRESSURES

TITON Pipe Fittings are able to withstand high pressures, use the table below as a guideline.

SPECIAL SIZES

Other threads/sizes not specified are available upon request.

ASSEMBLY

- I. Use pipe sealing compound.
- II. Tighten 1½ to 2½ turns past hand tight.

Thread Size	Hydraulic kPa [PSI]	Pneumatic kPa [PSI]
1/8	13750 [2000]	3500 [500]
1/4	13750 [2000]	3500 [500]
3/8	13750 [2000]	2750 [400]
1/2	10400 [1500]	2750 [400]
3/4	7000 [1020]	2000 [290]
1"	4000 [580]	1250 [180]

Pipe Fittings

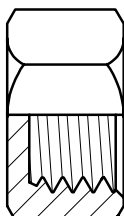
3133

Cap

Part Number	Standard Pack	Tube	Pipe Thread
313302	10	-	1/8 BSPP
313304	10	-	1/4 BSPP
313306	10	-	3/8 BSPP
313308	10	-	1/2 BSPP

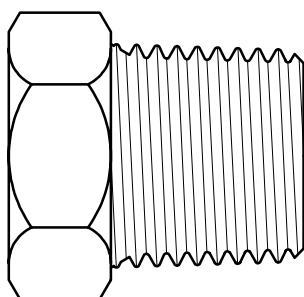
3152

Hex Plug

Available In Hollow and Solid Configurations.

Part Number	Standard Pack	Tube	Pipe Thread
315204	50	-	1/4 BSPT
315206	50	-	3/8 BSPT
315208	20	-	1/2 BSPT
315212	10	-	3/4 BSPT
315216	10	-	1" BSPT

Parts Listed Above Are Hollow, Parts Listed Below Are Solid

315202S	10	-	1/8 BSPT
315204S	10	-	1/4 BSPT
315206S	10	-	3/8 BSPT
315208S	10	-	1/2 BSPT
315212S	10	-	3/4 BSPT
315216S	10	-	1" BSPT

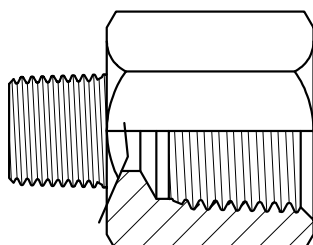
3200

Male To Female Adaptor

Part Number	Standard Pack	Pipe Thread (Female)	Pipe Thread (Male)
32000202	25	1/8 BSPP	1/8 BSPT
32000402	25	1/4 BSPP	1/8 BSPT
32000404	20	1/4 BSPP	1/4 BSPT
32000602	20	3/8 BSPP	1/8 BSPT
32000604	10	3/8 BSPP	1/4 BSPT
32000606	10	3/8 BSPP	3/8 BSPT
32000804	10	1/2 BSPP	1/4 BSPT
32000806	10	1/2 BSPP	3/8 BSPT
32000808	10	1/2 BSPP	1/2 BSPT
32001204	5	3/4 BSPP	1/4 BSPT
32001206	5	3/4 BSPP	3/8 BSPT
32001208	5	3/4 BSPP	1/2 BSPT
32001608	1	1" BSPT	1/2 BSPT

P
I
P
E

Pipe Fittings

Flush Mount Reducing Bush

Internal Hex Drive

Part Number	Standard Pack	Pipe Thread (Female)	Pipe Thread (Male)
32230402	20	1/8 BSPP	1/4 BSPT
32230604	15	1/4 BSPP	3/8 BSPT
32230806	10	3/8 BSPP	1/2 BSPT

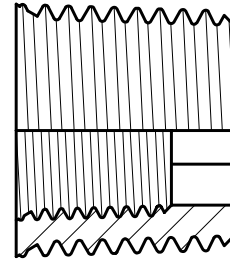

3223

Reducing Bush

Part Number	Standard Pack	Pipe Thread (Female)	Pipe Thread (Male)
32240402	50	1/8 BSPP	1/4 BSPT
32240602	50	1/8 BSPP	3/8 BSPT
32240604	50	1/4 BSPP	3/8 BSPT
32240802	20	1/8 BSPP	1/2 BSPT
32240804	20	1/4 BSPP	1/2 BSPT
32240806	20	3/8 BSPP	1/2 BSPT
32241202	20	1/8 BSPP	3/4 BSPT
32241204	20	1/4 BSPP	3/4 BSPT
32241206	20	3/8 BSPP	3/4 BSPT
32241208	20	1/2 BSPP	3/4 BSPT
32241606	1	3/8 BSPP	1" BSPT

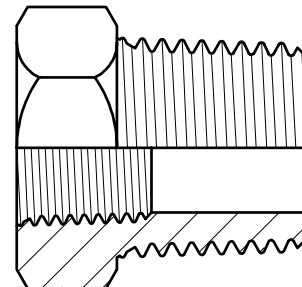

3224

Hex Socket

Part Number	Standard Pack	Tube	Pipe Thread
330002	50	-	1/8 BSPP
330004	25	-	1/4 BSPP
330006	20	-	3/8 BSPP
330008	10	-	1/2 BSPP
330012	5	-	3/4 BSPP
330016	5	-	1" BSPP

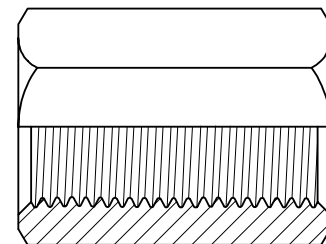

3300

P
I
P
E

Pipe Fittings

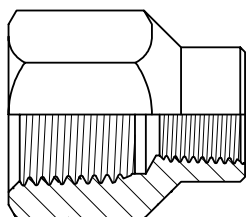
3304

Reducing Socket

Part Number	Standard Pack	Pipe Thread	Pipe Thread
33040402	20	1/4 BSPP	1/8 BSPP
33040602	20	3/8 BSPP	1/8 BSPP
33040604	20	3/8 BSPP	1/4 BSPP
33040802	10	1/2 BSPP	1/8 BSPP
33040804	10	1/2 BSPP	1/4 BSPP
33040806	10	1/2 BSPP	3/8 BSPP
33041206	10	3/4 BSPP	3/8 BSPP
33041208	10	3/4 BSPP	1/2 BSPP
33041612	1	1" BSPP	3/4 BSPP

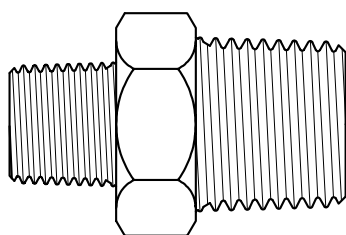
3324

Reducing Nipple

Part Number	Standard Pack	Pipe Thread	Pipe Thread
33240402	25	1/4 BSPT	1/8 BSPT
33240602	25	3/8 BSPT	1/8 BSPT
33240604	25	3/8 BSPT	1/4 BSPT
33240802	25	1/2 BSPT	1/8 BSPT
33240804	25	1/2 BSPT	1/4 BSPT
33240806	25	1/2 BSPT	3/8 BSPT
33241204	10	3/4 BSPT	1/4 BSPT
33241206	10	3/4 BSPT	3/8 BSPT
33241208	10	3/4 BSPT	1/2 BSPT
33241608	1	1" BSPT	1/2 BSPT
33241612	1	1" BSPT	3/4 BSPT

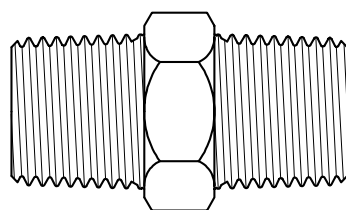
3325

Hex Nipple

Part Number	Standard Pack	Tube	Pipe Thread
332502	25	-	1/8 BSPT
332504	25	-	1/4 BSPT
332506	25	-	3/8 BSPT
332508	10	-	1/2 BSPT
332512	5	-	3/4 BSPT
332516	1	-	1" BSPT

**P
I
P
E**

Pipe Fittings

Barrel Nipple

Part Number	Standard Pack	Tube	Pipe Thread
332602	25	-	1/8 BSPT
332604	25	-	1/4 BSPT
332606	25	-	3/8 BSPT
332608	10	-	1/2 BSPT
332612	5	-	3/4 BSPT

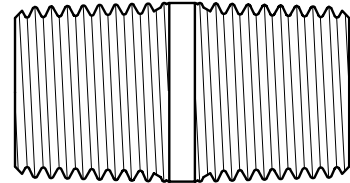
3326

Long Barrel Nipple

Part Number	Standard Pack	Pipe Thread	Length (Inches)
3327021.5	25	1/8 BSPT	1.5
3327022	25	1/8 BSPT	2
3327022.5	25	1/8 BSPT	2.5
3327023	25	1/8 BSPT	3
3327041.5	25	1/4 BSPT	1.5
3327042	25	1/4 BSPT	2
3327042.5	25	1/4 BSPT	2.5
3327043	25	1/4 BSPT	3
3327061.5	25	3/8 BSPT	1.5
3327062	25	3/8 BSPT	2
3327062.5	25	3/8 BSPT	2.5
3327063	20	3/8 BSPT	3
3327082	15	1/2 BSPT	2
3327082.5	10	1/2 BSPT	2.5
3327083	10	1/2 BSPT	3

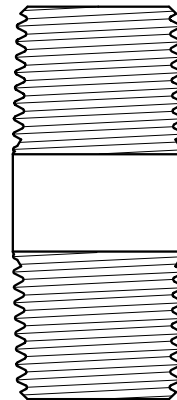
3327

Male To Female 90° Elbow

Part Number	Standard Pack	Pipe Thread (Female)	Pipe Thread (Male)
340002	25	1/8 BSPP	1/8 BSPT
340004	20	1/4 BSPP	1/4 BSPT
340006	10	3/8 BSPP	3/8 BSPT
340008	10	1/2 BSPP	1/2 BSPT

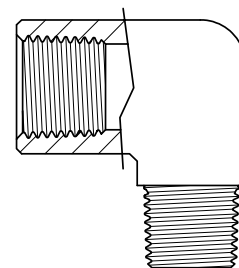
3400

See Next Page For 45° Elbows

**P
I
P
E**

Pipe Fittings

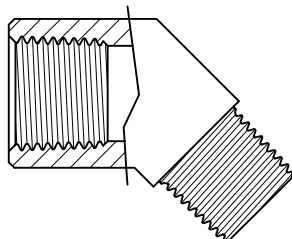
340045

Male To Female 45° Elbow

Part Number	Standard Pack	Pipe Thread (Female)	Pipe Thread (Male)
34004502	5	1/8 BSPP	1/8 BSPT
34004504	5	1/4 BSPP	1/4 BSPT
34004506	5	3/8 BSPP	3/8 BSPT
34004508	5	1/2 BSPP	1/2 BSPT

See Previous Page For 90° Elbows.

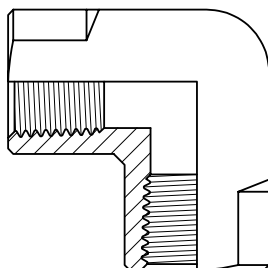
3500

Female 90° Elbow

Part Number	Standard Pack	Tube	Pipe Thread
350002	10	-	1/8 BSPP
350004	10	-	1/4 BSPP
350006	10	-	3/8 BSPP
350008	10	-	1/2 BSPP

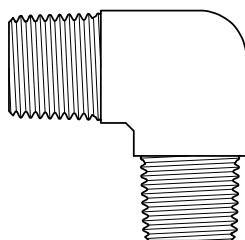
3600

Male 90° Elbow

Part Number	Standard Pack	Pipe Thread (Male)	Pipe Thread (Male)
36000202	10	1/8 BSPT	1/8 BSPT
36000402	10	1/4 BSPT	1/8 BSPT
36000404	10	1/4 BSPT	1/4 BSPT
36000604	10	3/8 BSPT	1/4 BSPT
36000606	10	3/8 BSPT	3/8 BSPT
36000806	10	1/2 BSPT	3/8 BSPT
36000808	10	1/2 BSPT	1/2 BSPT

P
I
P
E

Pipe Fittings

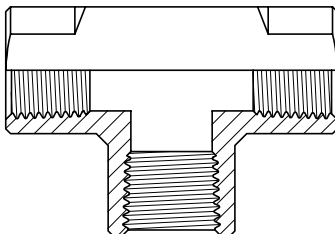
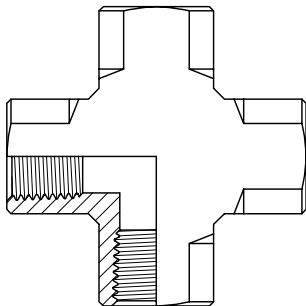
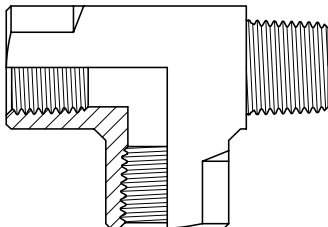
<div><div>Female Tee</div><table><thead><tr><th>Part Number</th><th>Standard Pack</th><th>Tube</th><th>Pipe Thread (Female)</th></tr></thead><tbody><tr><td>370002</td><td>10</td><td>-</td><td>1/8 BSPP</td></tr><tr><td>370004</td><td>10</td><td>-</td><td>1/4 BSPP</td></tr><tr><td>370006</td><td>10</td><td>-</td><td>3/8 BSPP</td></tr><tr><td>370008</td><td>10</td><td>-</td><td>1/2 BSPP</td></tr></tbody></table></div>	Part Number	Standard Pack	Tube	Pipe Thread (Female)	370002	10	-	1/8 BSPP	370004	10	-	1/4 BSPP	370006	10	-	3/8 BSPP	370008	10	-	1/2 BSPP	<div><div>3700</div></div>
Part Number	Standard Pack	Tube	Pipe Thread (Female)																		
370002	10	-	1/8 BSPP																		
370004	10	-	1/4 BSPP																		
370006	10	-	3/8 BSPP																		
370008	10	-	1/2 BSPP																		
<div><div>Female Cross</div><table><thead><tr><th>Part Number</th><th>Standard Pack</th><th>Tube</th><th>Pipe Thread (Female)</th></tr></thead><tbody><tr><td>390002</td><td>10</td><td>-</td><td>1/8 BSPP</td></tr><tr><td>390004</td><td>10</td><td>-</td><td>1/4 BSPP</td></tr><tr><td>390006</td><td>10</td><td>-</td><td>3/8 BSPP</td></tr><tr><td>390008</td><td>10</td><td>-</td><td>1/2 BSPP</td></tr></tbody></table></div>	Part Number	Standard Pack	Tube	Pipe Thread (Female)	390002	10	-	1/8 BSPP	390004	10	-	1/4 BSPP	390006	10	-	3/8 BSPP	390008	10	-	1/2 BSPP	<div><div>3900</div></div>
Part Number	Standard Pack	Tube	Pipe Thread (Female)																		
390002	10	-	1/8 BSPP																		
390004	10	-	1/4 BSPP																		
390006	10	-	3/8 BSPP																		
390008	10	-	1/2 BSPP																		
<div><div>Male Run/Female Tee</div><table><thead><tr><th>Part Number</th><th>Standard Pack</th><th>Pipe Thread (Male)</th><th>Pipe Thread (Female)</th></tr></thead><tbody><tr><td>400002</td><td>10</td><td>1/8 BSPT</td><td>1/8 BSPT</td></tr><tr><td>400004</td><td>10</td><td>1/4 BSPT</td><td>1/4 BSPT</td></tr><tr><td>400006</td><td>10</td><td>3/8 BSPT</td><td>3/8 BSPT</td></tr></tbody></table></div>	Part Number	Standard Pack	Pipe Thread (Male)	Pipe Thread (Female)	400002	10	1/8 BSPT	1/8 BSPT	400004	10	1/4 BSPT	1/4 BSPT	400006	10	3/8 BSPT	3/8 BSPT	<div><div>4000</div></div>				
Part Number	Standard Pack	Pipe Thread (Male)	Pipe Thread (Female)																		
400002	10	1/8 BSPT	1/8 BSPT																		
400004	10	1/4 BSPT	1/4 BSPT																		
400006	10	3/8 BSPT	3/8 BSPT																		

**P
I
P
E**

NPT Pipe Fittings

NPT3200BSP

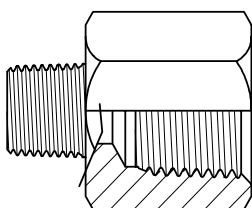

Male BSP to Female NPT adaptor

Part Number	Standard Pack	Pipe Thread (Male)	Pipe Thread (Female)
NPT32000202BSP	1	1/8 NPT	1/8 BSPT
NPT32000404BSP	1	1/4 NPT	1/4 BSPT
NPT32000606BSP	1	3/8 NPT	3/8 BSPT
NPT32000808BSP	1	1/2 NPT	

3300NPT

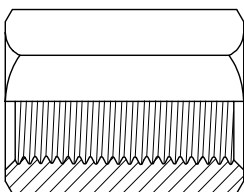

NPT Hex Socket

Part Number	Standard Pack	NPT Thread
330002NPT	1	1/8
330004NPT	1	1/4
330006NPT	1	3/8

3152NPT

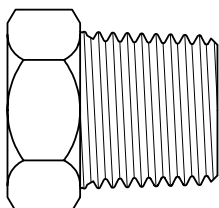

NPT Hex Plug

Available In Hollow and Solid Configuration

Part Number	Standard Pack	NPT Thread
315202NPT	1	1/8
315204NPT	1	1/4
315206NPT	1	3/8
315208NPT	1	1/2

P
I
P
E

Lever Taps & Cocks



Lever Taps are precision manufactured and ground to ensure positive shut off action. They are available in sizes ranging from 1/8" to 1/2", and are manufactured from high quality grade brass alloy.

ADVANTAGES

Lever Taps are compact and particularly suitable for confined spaces. Ground spindle and seat provide good metal to metal sealing properties.

APPLICATIONS

Use where lower pressures exist and precise volume/pressure control is not required. Suitable for fuel, air and water.

WORKING PRESSURES

Lever Taps should be used where pressures do not exceed 825 kPa [120 PSI].

Lever Taps & Cocks

DB1

Bent Drain Cock

Part Number	Standard Pack	Tube	Pipe Thread
042064-B02	1	-	1/8 BSPT
042064-B04	1	-	1/4 BSPT
042064-CB04	1	-	1/4 BSPT

042064-CB04 is Chrome Plated

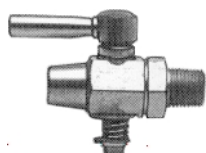
DT3

Drain Cock

Part Number	Standard Pack	Tube	Pipe Thread
042064-02	1	-	1/8 BSPT
042064-04	1	-	1/4 BSPT
042064-06	1	-	3/8 BSPT

IN LINE OFF

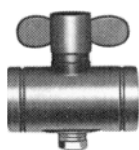
104

Female Lever Tap

Part Number	Standard Pack	Tube	Pipe Thread
042026-02	1	-	1/8 BSPP
042026-04	1	-	1/4 BSPP

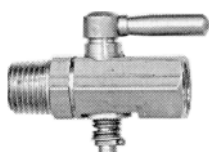
404

Male To Female Lever Tap

Part Number	Standard Pack	Pipe Thread (Female)	Pipe Thread (Male)
042072-02	1	1/8 BSPP	1/8 BSPT
042072-04	1	1/4 BSPP	1/4 BSPT

T
A
P
S

Needle Valves



Needle Valves allow precise control from fully off to fully on. Manufactured from high quality DZR brass alloy, Needle Valves are available in a variety of connections with sizes ranging from 1/8" to 3/8". In all needle valves Viton o'rings are used.

ADVANTAGES

Precise control due to metal to metal seals and fine thread screw-down. Good pressure rating. Suitable for fuels, water and air.

APPLICATIONS

Precision instrumentation, hydraulic control systems, and anywhere precise control is needed.

WORKING PRESSURES AND TEMPERATURE

TITON Needle Valves should not be used where pressures exceed 3447 kPa [500 PSI] or 100°C.

ASSEMBLY

Where possible, pressure side should be toward valve seat, not spindle.

All Needle valves except NV41, NV43, NVP40 are approved for use with gas (A.G.A. Approval :4104).

Operating Temperature 0 to +90°

Needle Valves

NV40



45° Flare Angle Needle Valve

Part Number	Standard Pack	Tube	Pipe Thread
041008-0402	1	1/4	1/8 BSPT
041008-0502	1	5/16	1/8 BSPT
041008-0604	1	3/8	1/4 BSPT

NV41



Compression Angle Needle Valve

Part Number	Standard Pack	Tube	Pipe Thread
041005-0302	1	3/16	1/8 BSPT
041005-0402	1	1/4	1/8 BSPT
041005-0502	1	5/16	1/8 BSPT
041005-0604	1	3/8	1/4 BSPT



NV43



Compression Male Needle Valve

Part Number	Standard Pack	Tube	Pipe Thread
041003-0302	1	3/16	1/8 BSPT
041003-0402	1	1/4	1/8 BSPT

Needle Valves

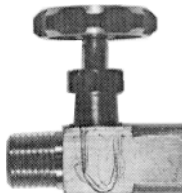
<div>Barb Angle Needle Valve</div> <table><tr><th>Part Number</th><th>Standard Pack</th><th>Tube</th><th>Pipe Thread</th></tr><tr><td>041606-0302</td><td>1</td><td>3/16</td><td>1/8 BSPT</td></tr><tr><td>041606-0402</td><td>1</td><td>1/4</td><td>1/8 BSPT</td></tr><tr><td>041606-0502</td><td>1</td><td>5/16</td><td>1/8 BSPT</td></tr><tr><td>041606-0504</td><td>1</td><td>5/16</td><td>1/4 BSPT</td></tr><tr><td>041606-0602</td><td>1</td><td>3/8</td><td>1/8 BSPT</td></tr><tr><td>041606-0604</td><td>1</td><td>3/8</td><td>1/4 BSPT</td></tr></table>	Part Number	Standard Pack	Tube	Pipe Thread	041606-0302	1	3/16	1/8 BSPT	041606-0402	1	1/4	1/8 BSPT	041606-0502	1	5/16	1/8 BSPT	041606-0504	1	5/16	1/4 BSPT	041606-0602	1	3/8	1/8 BSPT	041606-0604	1	3/8	1/4 BSPT	<div>NVP40</div> <div></div>
Part Number	Standard Pack	Tube	Pipe Thread																										
041606-0302	1	3/16	1/8 BSPT																										
041606-0402	1	1/4	1/8 BSPT																										
041606-0502	1	5/16	1/8 BSPT																										
041606-0504	1	5/16	1/4 BSPT																										
041606-0602	1	3/8	1/8 BSPT																										
041606-0604	1	3/8	1/4 BSPT																										
<div>Female Needle Valve</div> <table><tr><th>Part Number</th><th>Standard Pack</th><th>Tube</th><th>Pipe Thread</th></tr><tr><td>041026-02</td><td>1</td><td>-</td><td>1/8 BSPP</td></tr><tr><td>041026-04</td><td>1</td><td>-</td><td>1/4 BSPP</td></tr><tr><td>041026-06</td><td>1</td><td>-</td><td>3/8 BSPP</td></tr></table>	Part Number	Standard Pack	Tube	Pipe Thread	041026-02	1	-	1/8 BSPP	041026-04	1	-	1/4 BSPP	041026-06	1	-	3/8 BSPP	<div>NV104</div> <div></div>												
Part Number	Standard Pack	Tube	Pipe Thread																										
041026-02	1	-	1/8 BSPP																										
041026-04	1	-	1/4 BSPP																										
041026-06	1	-	3/8 BSPP																										
<div>Male Needle Valve</div> <table><tr><th>Part Number</th><th>Standard Pack</th><th>Tube</th><th>Pipe Thread</th></tr><tr><td>041027-02</td><td>1</td><td>-</td><td>1/8 BSPT</td></tr><tr><td>041027-04</td><td>1</td><td>-</td><td>1/4 BSPT</td></tr></table>	Part Number	Standard Pack	Tube	Pipe Thread	041027-02	1	-	1/8 BSPT	041027-04	1	-	1/4 BSPT	<div>NV105</div> <div></div>																
Part Number	Standard Pack	Tube	Pipe Thread																										
041027-02	1	-	1/8 BSPT																										
041027-04	1	-	1/4 BSPT																										
<div>Male to Female Needle Valve</div> <table><tr><th>Part Number</th><th>Standard Pack</th><th>Pipe Thread (Female)</th><th>Pipe Thread (Male)</th></tr><tr><td>041072-02</td><td>1</td><td>1/8 BSPP</td><td>1/8 BSPT</td></tr><tr><td>041072-04</td><td>1</td><td>1/4 BSPP</td><td>1/4 BSPT</td></tr></table>	Part Number	Standard Pack	Pipe Thread (Female)	Pipe Thread (Male)	041072-02	1	1/8 BSPP	1/8 BSPT	041072-04	1	1/4 BSPP	1/4 BSPT	<div>NV404</div> <div></div>																
Part Number	Standard Pack	Pipe Thread (Female)	Pipe Thread (Male)																										
041072-02	1	1/8 BSPP	1/8 BSPT																										
041072-04	1	1/4 BSPP	1/4 BSPT																										

45° Flare

**F
L
A
R
E**

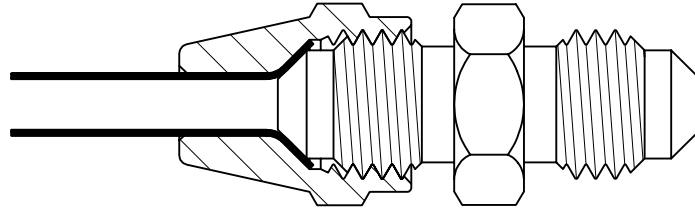

TITON Flare Fittings are manufactured especially with hazardous liquids and gasses in mind. They are available in sizes ranging from 1/8" to 3/4", and are manufactured from high quality DZR grade brass alloy . All flare fittings conform to the following standards: AS D26, AS3688, AG 601-1995, NZG 1993/76.

ADVANTAGES

May be assembled/disassembled numerous times. When used with the appropriate tubing, they can withstand high pressures. For improved resistance to mechanical vibration, the Long Flare Nut may be used.

APPLICATIONS

Use with copper, brass, aluminium, and flareable steel pipe. Install where medium to high pressures are encountered. Flare Fittings, when used with the Long Flare Nut, provide good resistance to vibration. Ideal for use with fuel, oil, air, water and Natural Gas lines. In Applications where temperatures extremes are encountered we recommend the use of stress-relieved fittings. Please contact our technical sales department for more information.

WORKING PRESSURES

TITON Flare Fittings are able to withstand high pressures, use the table below as a guideline. Usually, pressures are determined by the pipe used, rather than the Flare Fitting.

SPECIAL SIZES

Other sizes not specified are available upon request.

ASSEMBLY

- I. Slide nut, tapered end first, onto tubing.
- II. Using a 45° flaring tool, flare end of tube until flare just fits inside nut. (On thin wall tubing it is recommended a double flare is used to prevent pinch off.)
- III. Assemble to fitting body. Nut should be tightened hand tight.
- IV. Using a wrench, tighten until a leak-proof, metal to metal joint is achieved. To avoid premature failure of the fitting, do not over-tighten.

Tube Size	Hydraulic kPa [PSI]	Pneumatic kPa [PSI]
1/8	17250 [2500]	4800 [700]
3/16	17250 [2500]	4800 [700]
1/4	13750 [2000]	4800 [700]
5/16	13750 [2000]	4800 [700]
3/8	10400 [1500]	2750 [400]
1/2	7000 [1020]	1750 [250]
5/8	7000 [1020]	1750 [250]
3/4	7000 [1020]	1750 [250]

45° Flare

39P

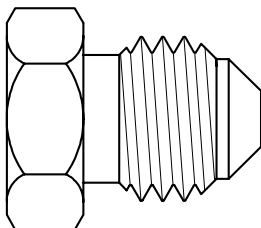

Flare Plug

Part Number	Standard Pack	Tube	Pipe Thread
39P04	5	1/4	-
39P05	5	5/16	-
39P06	5	3/8	-
39P08	5	1/2	-
39P10	5	5/8	-

40C

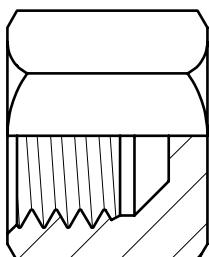

Flare Cap

Part Number	Standard Pack	Tube	Pipe Thread
40C04	5	1/4	-
40C05	5	5/16	-
40C06	5	3/8	-
40C08	5	1/2	-

41S

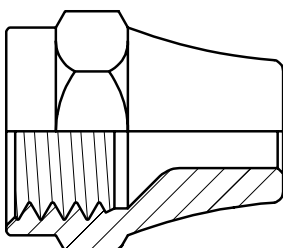

Short Flare Nut

Part Number	Standard Pack	Tube	Pipe Thread
41S02	50	1/8	-
41S03	50	3/16	-
41S04	50	1/4	-
41S05	50	5/16	-
41S06	25	3/8	-
41S08	20	1/2	-
41S10	10	5/8	-
41S12	10	3/4	-

45° Flare

**F
L
A
R
E**

Long Flare Nut

Offers Improved Resistance To Vibration.

Part Number	Standard Pack	Tube	Pipe Thread
4102	25	1/8	-
4103	25	3/16	-
4104	25	1/4	-
4105	25	5/16	-
4106	25	3/8	-
4108	20	1/2	-
4110	10	5/8	-
4112	10	3/4	-

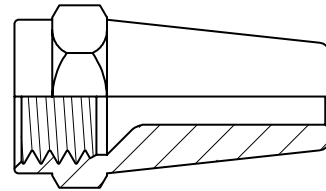

41

Double Flare Union

For Reducing Unions See No 58.

Part Number	Standard Pack	Tube	Pipe Thread
4202	20	1/8	-
4203	20	3/16	-
4204	25	1/4	-
4205	25	5/16	-
4206	25	3/8	-
4208	10	1/2	-
4210	10	5/8	-
4212	10	3/4	-

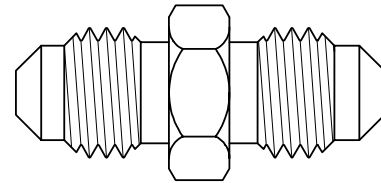

42

Flare Tee

For Reducing Unions See No 58.

Part Number	Standard Pack	Tube	Pipe Thread
4402	10	1/8	-
4403	10	3/16	-
4404	10	1/4	-
4405	10	5/16	-
4406	10	3/8	-
4408	10	1/2	-
4410	10	5/8	-
4412	10	3/4	-

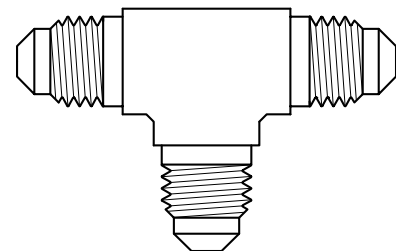

44

45° Flare

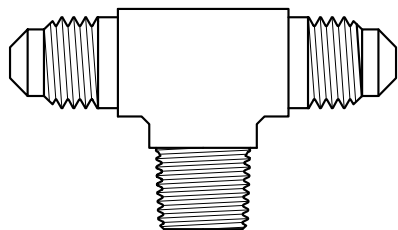
45

Flare Male Branch Tee

Part Number	Standard Pack	Tube	Pipe Thread
450202	10	1/8	1/8 BSPT
450302	10	3/16	1/8 BSPT
450402	10	1/4	1/8 BSPT
450404	10	1/4	1/4 BSPT
450502	10	5/16	1/8 BSPT
450604	10	3/8	1/4 BSPT
450806	10	1/2	3/8 BSPT

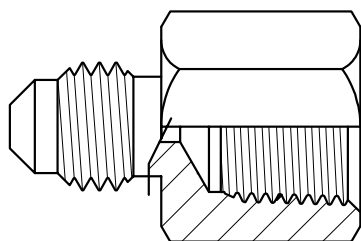
46

Flare Female Connector

Part Number	Standard Pack	Tube	Pipe Thread
460202	10	1/8	1/8 BSPP
460302	10	3/16	1/8 BSPP
460402	10	1/4	1/8 BSPP
460404	10	1/4	1/4 BSPP
460406	10	1/4	3/8 BSPP
460502	10	5/16	1/8 BSPP
460504	10	5/16	1/4 BSPP
460602	10	3/8	1/8 BSPP
460604	10	3/8	1/4 BSPP
460606	10	3/8	3/8 BSPP
460608	10	3/8	1/2 BSPP
460804	10	1/2	1/4 BSPP
460806	10	1/2	3/8 BSPP
460808	10	1/2	1/2 BSPP
461208	10	3/4	1/2 BSPP
461212	1	3/4	3/4 BSPP

45° Flare

**F
L
A
R
E**

Flare Male Connector

Part Number	Standard Pack	Tube	Pipe Thread
480202	20	1/8	1/8 BSPT
480302	20	3/16	1/8 BSPT
480304	-	3/16	1/4 BSPT
480402	20	1/4	1/8 BSPT
480404	20	1/4	1/4 BSPT
480406	20	1/4	3/8 BSPT
480408	20	1/4	1/2 BSPT
480502	20	5/16	1/8 BSPT
480504	20	5/16	1/4 BSPT
480506	20	5/16	3/8 BSPT
480508	-	5/16	1/2 BSPT
480602	20	3/8	1/8 BSPT
480604	20	3/8	1/4 BSPT
480606	20	3/8	3/8 BSPT
480608	20	3/8	1/2 BSPT
480612	10	3/8	3/4 BSPT
480804	20	1/2	1/4 BSPT
480806	10	1/2	3/8 BSPT
480808	10	1/2	1/2 BSPT
480812	-	1/2	3/4 BSPT
481006	5	5/8	3/8 BSPT
481008	5	5/8	1/2 BSPT
481012	5	5/8	3/4 BSPT
481208	5	3/4	1/2 BSPT
481212	5	3/4	3/4 BSPT

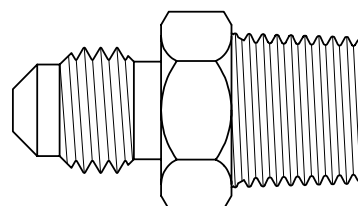

48

Flare Male Elbow

Part Number	Standard Pack	Tube	Pipe Thread
490202	20	1/8	1/8 BSPT
490302	20	3/16	1/8 BSPT
490402	25	1/4	1/8 BSPT
490404	25	1/4	1/4 BSPT
490406	25	1/4	3/8 BSPT
490502	25	5/16	1/8 BSPT
490504	25	5/16	1/4 BSPT
490506	25	5/16	3/8 BSPT

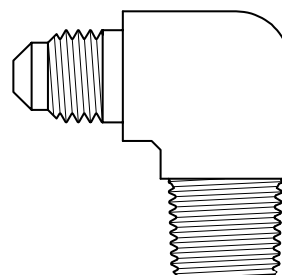

49

Continued on next page...

45° Flare

...Continued from previous page

49

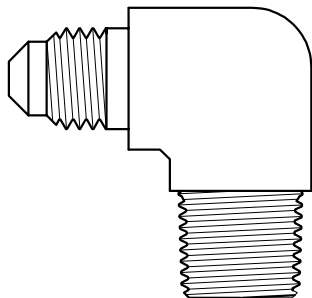

Flare Male Elbow

Part Number	Standard Pack	Tube	Pipe Thread
490602	20	3/8	1/8 BSPT
490604	20	3/8	1/4 BSPT
490606	10	3/8	3/8 BSPT
490608	10	3/8	1/2 BSPT
490804	10	1/2	1/4 BSPT
490806	10	1/2	3/8 BSPT
490808	10	1/2	1/2 BSPT
491008	5	5/8	1/2 BSPT
491208	5	5/8	1/2 BSPT

50

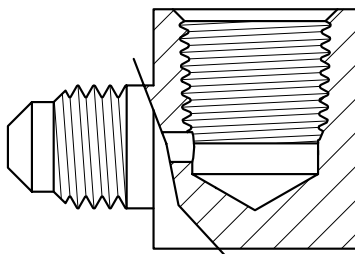

Flare Female Elbow

Part Number	Standard Pack	Tube	Pipe Thread
500402	1	1/4	1/8 BSPP
500502	1	5/16	1/8 BSPP
500604	1	3/8	1/4 BSPP
500806	1	1/2	3/8 BSPP

51

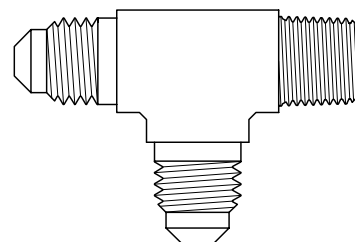

Flare Male Run Tee

Part Number	Standard Pack	Tube	Pipe Thread
510402	1	1/4	1/8 BSPT
510604	1	5/16	1/4 BSPT
510806	1	3/8	3/8 BSPT

45° Flare

**F
L
A
R
E**

Flare 90° Elbow

Part Number	Standard Pack	Tube	Pipe Thread
5502	10	1/8	-
5503	10	3/16	-
5504	10	1/4	-
5505	10	5/16	-
5506	10	3/8	-
5508	10	1/2	-
5510	10	5/8	-

55

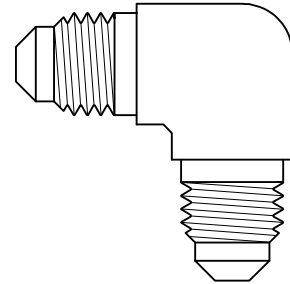

Reducing Flare Union

For Double Flare Unions See No 42.

Part Number	Standard Pack	Tube	Tube
580403	10	1/4	42430
580504	10	5/16	38808
580604	10	3/8	38808
580605	10	3/8	42491
580806	10	1/2	38932

58

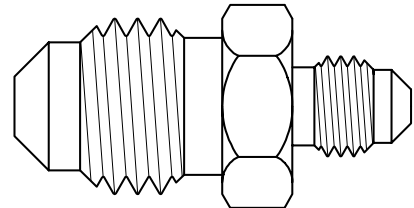

45° Gas Flare

GFC

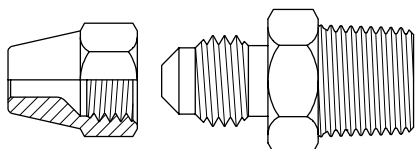

Gas Flare Assembly

Consists of GFN Nut and GFM Connector

Part Number	Standard Pack	Tube	Pipe Thread
GFC1006	10	10 mm	3/8 BSPT
GFC1008	10	10 mm	1/2 BSPT
GFC1508	10	15 mm	1/2 BSPT
GFC2012	10	20 mm	3/4 BSPT

GFF

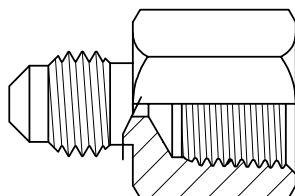

Stress Relieved

Gas Flare Female Connector

Part Number	Standard Pack	Tube	Pipe Thread
GFF1508	10	15 mm	1/2 BSPT
GFF2012	10	20 mm	3/4 BSPT

GFN

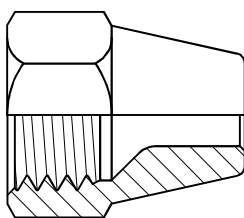

Stress Relieved

Gas Flare Nut

Part Number	Standard Pack	Tube	Pipe Thread
GFN10	10	10 mm	-
GFN15	10	15 mm	-
GFN20	10	20 mm	-

45° Inverted Flare

**F
L
A
R
E**

Inverted Flare Nut

105

Part Number	Standard Pack	Tube	Pipe Thread
10502	20	1/8	-
10503	20	3/16	-
10504	20	1/4	-
10505	20	5/16	-
10506	20	3/8	-
10508	10	1/2	-

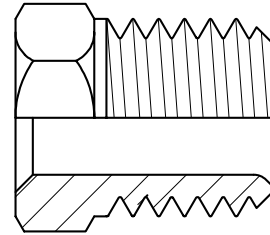

Inverted Flare Male Connector

200

Part Number	Standard Pack	Tube	Pipe Thread
2000302	20	3/16	1/8 BSPT
2000402	20	1/4	1/8 BSPT
2000404	20	1/4	1/4 BSPT
2000502	20	5/16	1/8 BSPT
2000504	20	5/16	1/4 BSPT
2000604	10	3/8	1/4 BSPT
2000806	10	1/2	3/8 BSPT

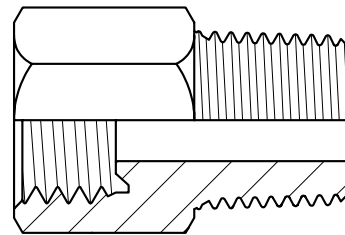

Inverted Flare Male Elbow

400

Part Number	Standard Pack	Tube	Pipe Thread
4000202	10	1/8	1/8 BSPT
4000302	10	3/16	1/8 BSPT
4000402	20	1/4	1/8 BSPT
4000404	20	1/4	1/4 BSPT
4000502	20	5/16	1/8 BSPT
4000504	20	5/16	1/4 BSPT
4000604	10	3/8	1/4 BSPT
4000606	10	3/8	3/8 BSPT
4000806	10	1/2	3/8 BSPT

